

VDR-11A-*A*-*A*-*22

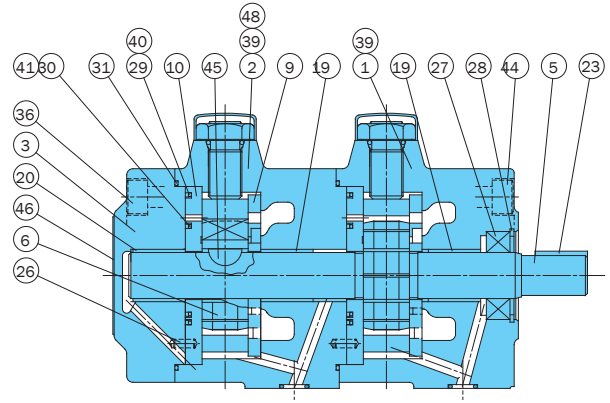
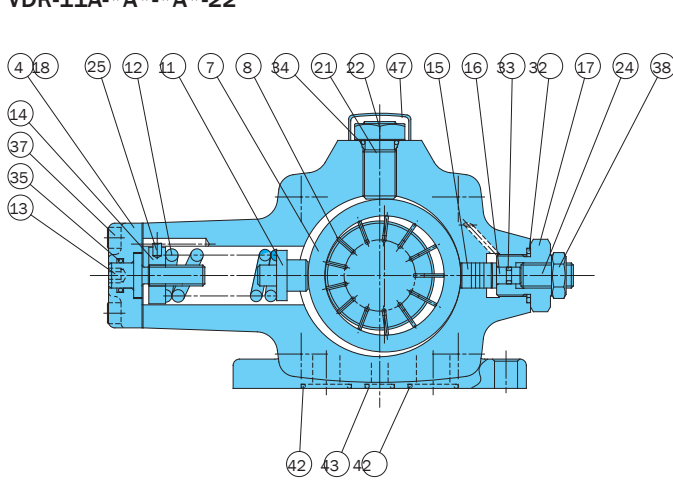

Uni-Pump Specifications

(CE mark standard compliant)

Understanding Model Numbers

Single Pump

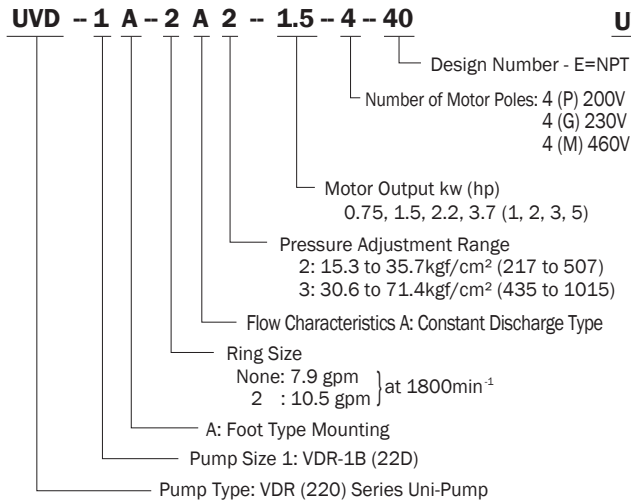

Double Pump

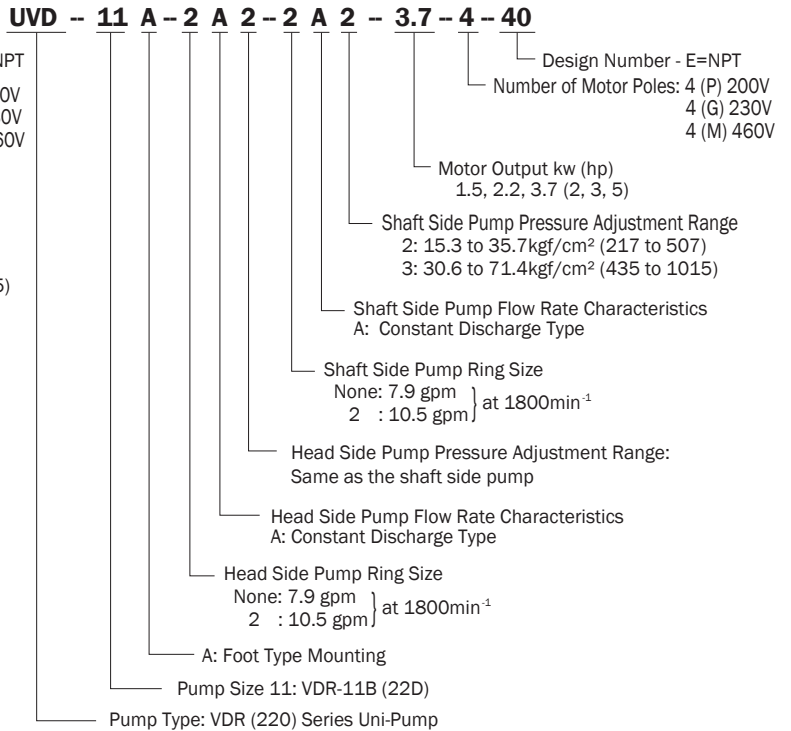

Specifications

Model No.	Maximum Working Pressure kgf/cm ² (psi)	Maximum Flow Rate gpm (A*)		Maximum Flow Rate gpm (2A*)	
		50Hz	60Hz	50Hz	60Hz
UVD-1A	71.4 (1015)	6.6	7.9	8.7	10.5
UVD-11A	71.4 (1015)				

Motor Selection Curves

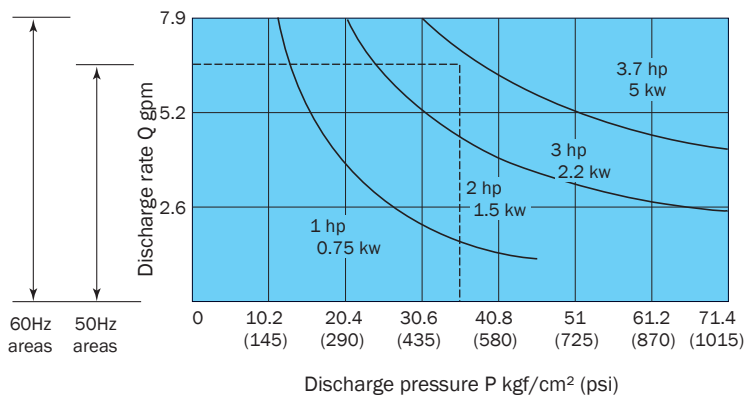

• **Selecting a motor**
The area under a motor output curve in the graph to the left is the operating range for that motor under the rated output for that motor.

Example:
To find the motor that can produce pressure of 435 psi and a discharge rate of 6.6 gpm.

Selection Process:
Since the intersection of the two broken lines from a pressure of 435 psi and discharge rate of 6.6 gpm intersect in the area under the 3 hp curve, it means that a 3 hp motor should be used. In the case of a double pump configuration, select a motor that is larger than the total power required by both pumps.

* Select a uni-pump that has a pressure and flow rate that is within the range of the drive so that the drive will not overload.

Installation Dimension Drawings
UVD-1A

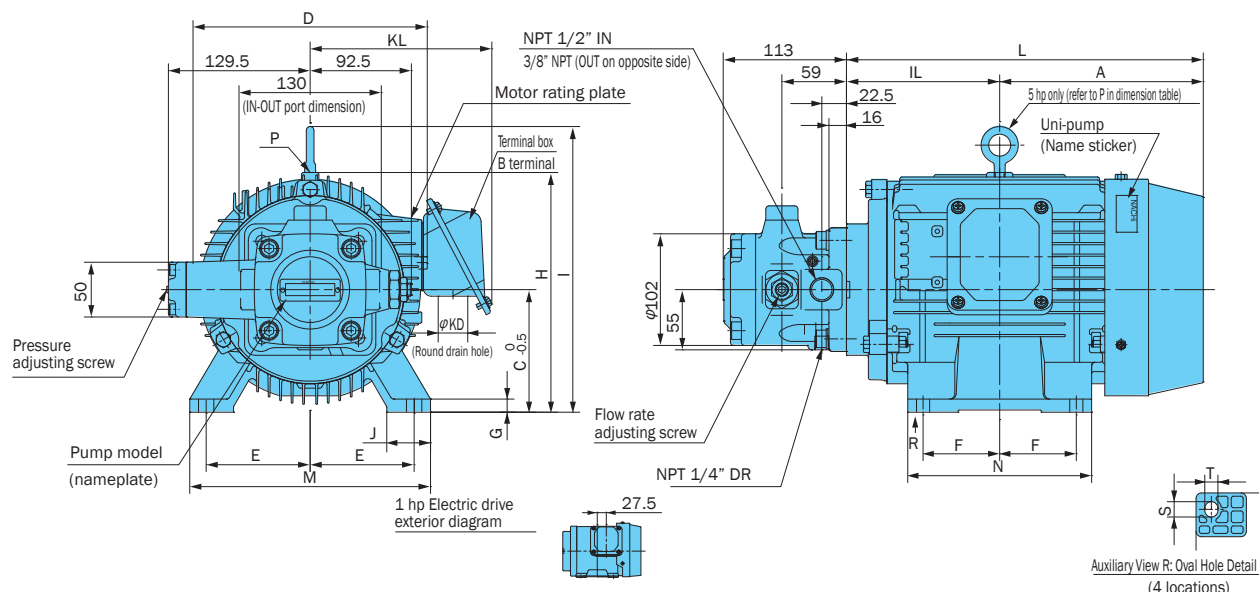

Uni-pump	Motor Dimensions mm																Frame No.	Output hp (4 poles)	Weight lbs	
	A	IL	C	D	E	F	G	H	I	J	L	M	N	S x T	KD	KL				O
UVD-1A-A2-0.75-4-40	133	105	80	170	62.5	50	4.5	165	-	35	238	165	130	18x10	ø27	157	27.5	80M	1	53
UVD-1A-A2-1.5-4-40	143	118.5	90	198	70	62.5	10	190	-	40	261.5	176	150	12x10	ø27	159	-	90L	2	55
UVD-1A-A3-1.5-4-40																				
UVD-1A-2A2-1.5-4-40	157.5	133	100	198	80	70	12	200	-	40	290.5	200	168	14x12	ø27	159	-	100L	3	66
UVD-1A-A2-2.2-4-40																				
UVD-1A-A3-2.2-4-40																				
UVD-1A-2A2-2.2-4-40	186	140	112	214	95	70	12	-	261	40	326	220	168	14x12	ø27	166	-	112M	5	80
UVD-1A-A3-3.7-4-40																				
UVD-1A-2A2-3.7-4-40																				
UVD-1A-2A3-3.7-4-40																				

- 1 - 3 hp model does not have hangers.
- 1. Standard drive motor is the fully enclosed fan-cooled B type.
- 2. Standard voltage for drive motor is 200 VAC, 50/60 Hz or 220 VAC, 60 Hz.
- 3. Standard terminal box is B terminal (right side viewed from pump).
- 4. See page A-21 for the characteristics of the drive motor for the unipump (domestic standard 3 rating).

UVD-11A

B

Vane Pumps

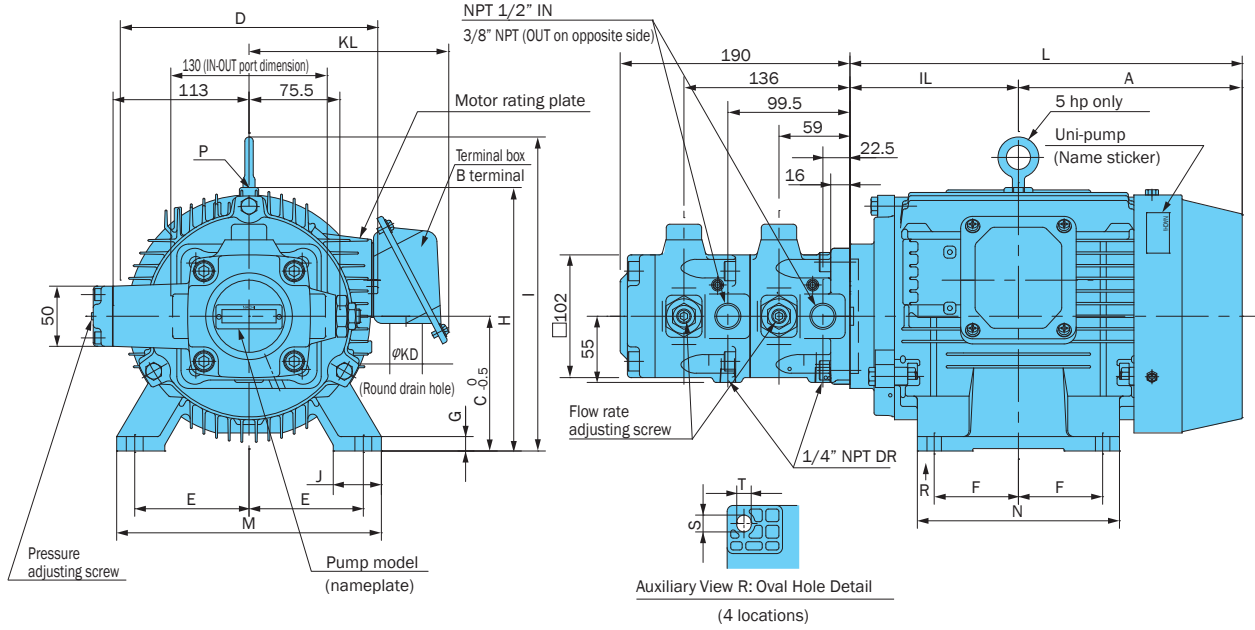

Uni-Pump	Motor Dimensions mm																	Frame No.	Output hp (4 poles)	Weight lbs
	A	IL	C	D	E	F	G	H	I	J	L	M	N	S × T	KD	KL	O			
UVD-11A-A2-A2-1.5-4-40	143	118.5	90	198	70	62.5	10	190	-	40	261.5	176	150	12 × 10	φ27	159	-	90L	2	73
UVD-11A-A2-A3-1.5-4-40																				
UVD-11A-A3-A3-1.5-4-40																				
UVD-11A-A2-A2-2.2-4-40	157.5	133	100	198	80	70	12	200	-	40	290.5	200	168	14 × 12	φ27	159	-	100L	3	84
UVD-11A-A2-A3-2.2-4-40																				
UVD-11A-A3-A3-2.2-4-40																				
UVD-11A-2A2-2A2-2.2-4-40	186	140	112	214	95	70	12	-	261	40	326	220	168	14 × 12	φ27	166	-	112M	5	97
UVD-11A-A2-A2-3.7-4-40																				
UVD-11A-A2-A3-3.7-4-40																				
UVD-11A-A3-A3-3.7-4-40																				
UVD-11A-2A2-2A2-3.7-4-40																				
UVD-11A-2A2-2A3-3.7-4-40																				

1. 2 to 3 hp model does not have hangers.
1. Standard drive motor is the fully enclosed fan-cooled B type.
2. Standard voltage for drive motor is 200 VAC, 50/60 Hz or 220 VAC, 60 Hz.
3. Standard terminal box is B terminal (right side viewed from pump).
4. See page A-21 for the characteristics of the drive motor for the unipump (domestic standard 3 rating).